

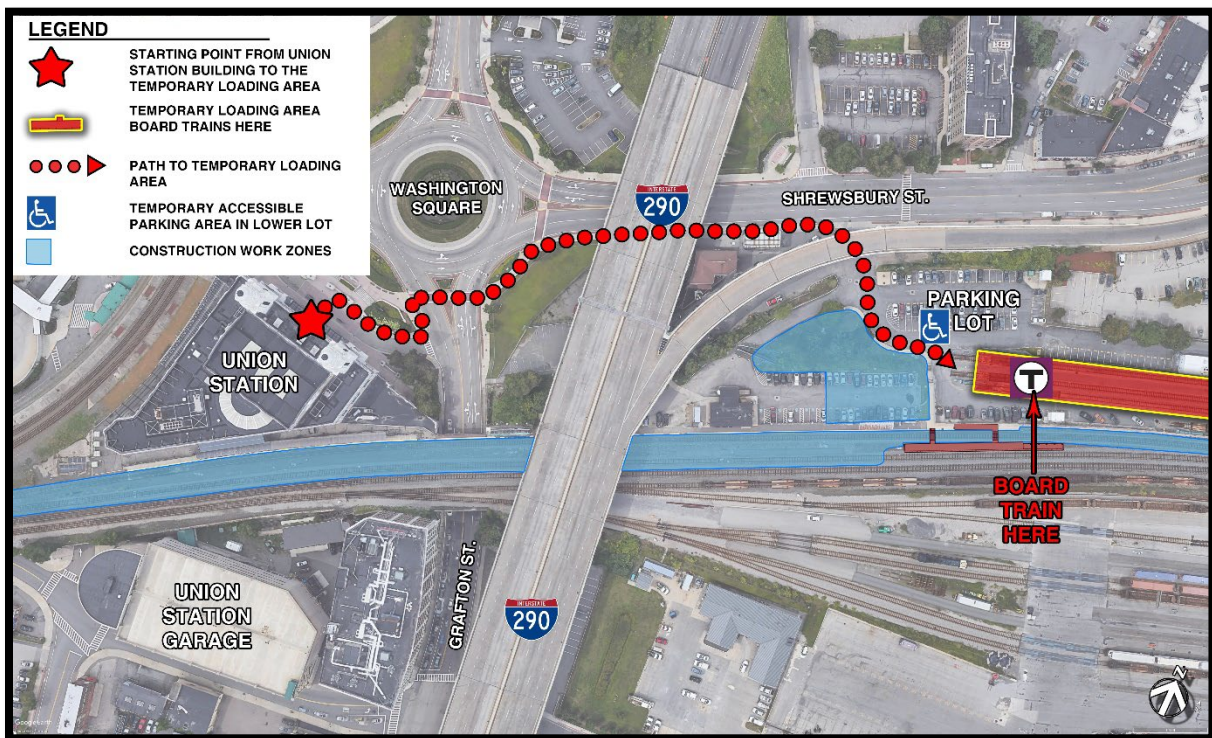

Worcester Union Station: Temporary Path of Travel for March 12 & 13



The MBTA has begun the work to upgrade the Worcester Union Station. **As part of the upgrades, the existing platform itself will be closed this weekend, March 12-13, with train service continuing from a temporary loading area east of the station**

For those accessing the lower parking lot to board the train by foot from the station, the image above outlines the path of travel. From Union Station, riders will continue around the Washington Square Rotary, along Shrewsbury Street, into the lower parking lot adjacent to Shrewsbury Street. Signage will direct riders from the station and Ambassadors will be on site to help direct riders to the temporary boarding area.

Accessible spaces will be available in the lower parking lot adjacent to Shrewsbury Street. These parking spots will be cordoned off with proper signage. There is a designated drop off area near the temporary boarding area.

Passengers should allow an additional 10 minutes to access the train at the temporary boarding area.

The MBTA Worcester Union Station Improvements Project Team recently recorded a project update where the details of the station upgrades work were presented.

To view the PowerPoint presentation or to watch the video recording of the update, please visit the project webpage, under "Recorded Project Overview".

www.mbta.com/projects/worcester-union-station-improvements

We appreciate your patience during this safety related closure and the associated construction to Worcester Union Station.

If you have any questions, or would like to sign up for project updates, please feel free to contact the project team at UnionStation@mbta.com

